

O-RING KIT FOR MANITOU REVOX COIL SHOCKS 2010-2015
 COMP = 4 WAY, EXPERT = 6 WAY WITH FIXED VOL, PRO = VOL ADJUST
 ALSO FITS ISX4 AND ISX6 COIL SHOCKS 2008-2010

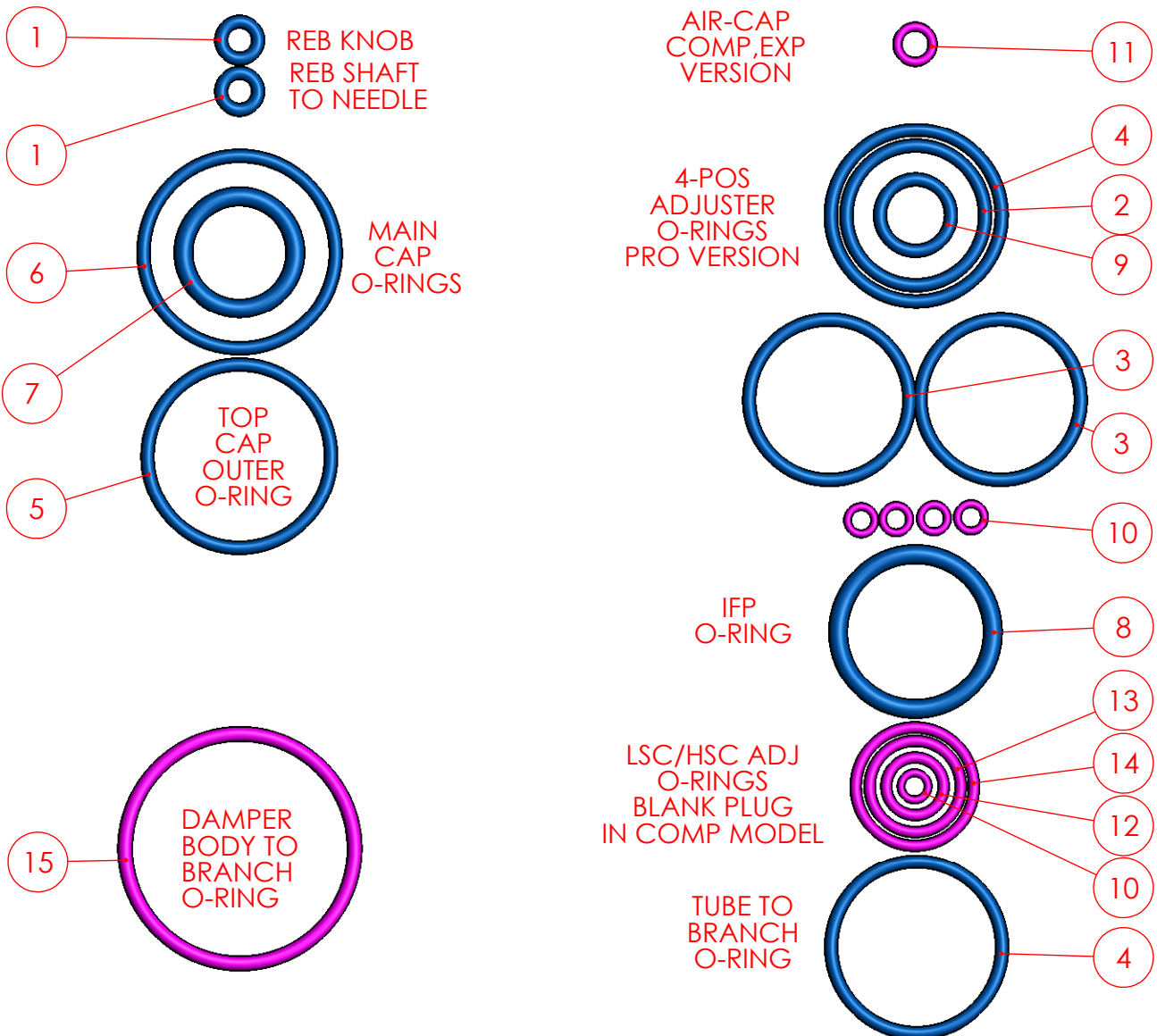

THIS DOCUMENT IS COPYRIGHT © SIGNAL HOLDINGS LTD. SHOCKCRAFT & ENGEN ARE REGISTERED TRADEMARKS OF SIGNAL HOLDINGS LTD

SERVICE INFO FOR MANITOU REVOX COIL SHOCKS 2010-2015

Oil Specification: Motorex 2.5wt (15 cSt)
 IFP Depth: See Table
 IFP Fill: Schrader Valve OR IFP KEYCHAIN TOOL
 IFP Pressure: 200psi - does not affect damping

IDENTIFICATION:

REVOX MODELS HAVE A 14MM SHAFT, PREVIOUS **SWINGERS** HAD 12.7mm SHAFTS

REVOX COMP 2010-2015 IS A PIGGY BACK SHOCK WITH SHIM STACK DAMPER - ADJUSTABLE REBOUND & PRELOAD.

REVOX EXPERT 2010-2015 IS A PIGGY BACK SHOCK WITH SHIM STACK DAMPER & COMP ADJUSTERS. ADJUSTABLE REBOUND, PRELOAD, LSC & HSC.

REVOX PRO 2010-2015 IS A PIGGY BACK SHOCK WITH SHIM STACK DAMPER & COMP ADJUSTERS. ADJUSTABLE REBOUND, PRELOAD, LSC & HSC & IFP VOLUME.

REVOX ISX4 2010-2015 IS A PIGGY BACK SHOCK WITH SHIM STACK DAMPER - ADJUSTABLE REBOUND & PRELOAD & TOOLED IFP VOLUME.

REVOX ISX6 2010-2015 IS A PIGGY BACK SHOCK WITH SHIM STACK DAMPER & COMP ADJUSTERS. ADJUSTABLE REBOUND, PRELOAD, LSC & HSC & IFP VOLUME.

IFP Depth TO PISTON OUTER LIP	SWINGER 4-6 WAY AIR	2004-2007 TOOLED VOLUME
Stroke Metric	Stroke Imperial	IFP Depth (mm)
38	1.5 inch	35
51	2 inch	38.5
57	2.25 inch	40
63	2.5 inch	41.5
70	2.75 inch	43
76	3 inch	44.5

BEST MANUAL BLEED IS BY THE SHAFT HOLE WHEN HEAD AND REBOUND NEEDLE REMOVED

TOOLS & SPARES:
 EYELET BUSHINGS - Shockcraft 12mm DU bushing UNTIL 2010
 1/2" DU Bushing (Monocrome) 2011+
 SHAFT WIPER SEAL - 14 mm D Type Wiper Seal - PU
 SHAFT BUSHING - 14 x 16 x 12 DU Bushing (Norglide)
 COMP IFP CAP & FILL - IFP Valve Tool Keychain (Manitou)